

Horizone Web Server

HORIZONE is a webserver specifically engineered for supervision and monitoring of Home & Building Automation systems. Based on KNX standard and suitable for integration with Modbus standard and other technologies used in intelligent buildings, alarm systems, fire and smoke detections systems, audio/video distribution systems. Compatible with operating system Mac OS X, Microsoft Windows, Apple iOS and Google Android, the configuration and use of HORIZONE takes place directly through its web interface, which can be accessed through a the most popular browser on the market browser from any device (pc/mac, smartphone e tablet) or with free app available on iOS and Android store.



SIZES

	KNX GROUP ADDRESSES	SCENES	LOGICS	PAGES	LOADS
Horizone Web Server 200 KNX group addresses	200	30	30	UNLIMITED	10
Upgrade up to 800 KNX group addresses	800	100	100	UNLIMITED	20
Upgrade up to 1400 KNX group addresses	1400	100	100	UNLIMITED	40

**On demand Horizone Upgrade over 1400 KNX group addresses

Order Codes

IN00B02WEB

Web Server Horizone 200 points

IN00B03UPG

Upgrade up to 800 points

IN00B04UPG

Upgrade up to 1400 points

Hardware Features

Mechanical data	<ul style="list-style-type: none"> Dimensions: 5 DIN modules
Supply	<ul style="list-style-type: none"> Via bus EIB/KNX cable: 21 ÷ 32 Vdc
Aux Supply	<ul style="list-style-type: none"> 12 ÷ 24 Vdc 18 mA @12 V; 110 mA @24 V
Communication ports	<ul style="list-style-type: none"> KNX RS232 (1x) Screw connector RS485 (1x) Screw connector USB 2.0 (2x) LAN (1x) RJ-45 jack (10/100 Mbps)

Additional Software Modules

IN00B02MBS	<ul style="list-style-type: none"> MODBUS Module for HORIZONE WS
IN00B02BEN	<ul style="list-style-type: none"> BENTEL Module for HORIZONE WS
IN00B02IES	<ul style="list-style-type: none"> ELMO/IESS Module for HORIZONE WS
IN00B02TEC	<ul style="list-style-type: none"> TECNOALARM Module for HORIZONE WS
IN00B02TUT	<ul style="list-style-type: none"> TUTONDO Module for HORIZONE WS
IN00B02VIV	<ul style="list-style-type: none"> VIVALDI Module for HORIZONE WS
IN00B02VOI	<ul style="list-style-type: none"> VOIP Module for HORIZONE WS
IN00B02SON	<ul style="list-style-type: none"> SONOS Module for HORIZONE WS
IN00B02DAT	<ul style="list-style-type: none"> Report and Accounting Module for HORIZONE WS

Software Features

Standard technologies	<ul style="list-style-type: none"> KNX RS232 / RS485 / TCP
User interface	<ul style="list-style-type: none"> Web / HTML5 App iOS / Android
Number of clients	<ul style="list-style-type: none"> Unlimited
Simultaneous connections	<ul style="list-style-type: none"> Up to 20
Features	<ul style="list-style-type: none"> Lighting HVAC Blinds / Shutters Irrigation Alarms Power consumption Load management Weather IP Camera Door intercom system (with SIP standard) Cloud services Voice control IFTTT
Advanced functions	<ul style="list-style-type: none"> Scenarios with parametrical wait functions Boolean logics Thresholds and values comparators Mathematical operations Scheduler Notifications Advanced logic module
Users and security	<ul style="list-style-type: none"> Unlimited users SSL Internet secure access

Horizon Web Server

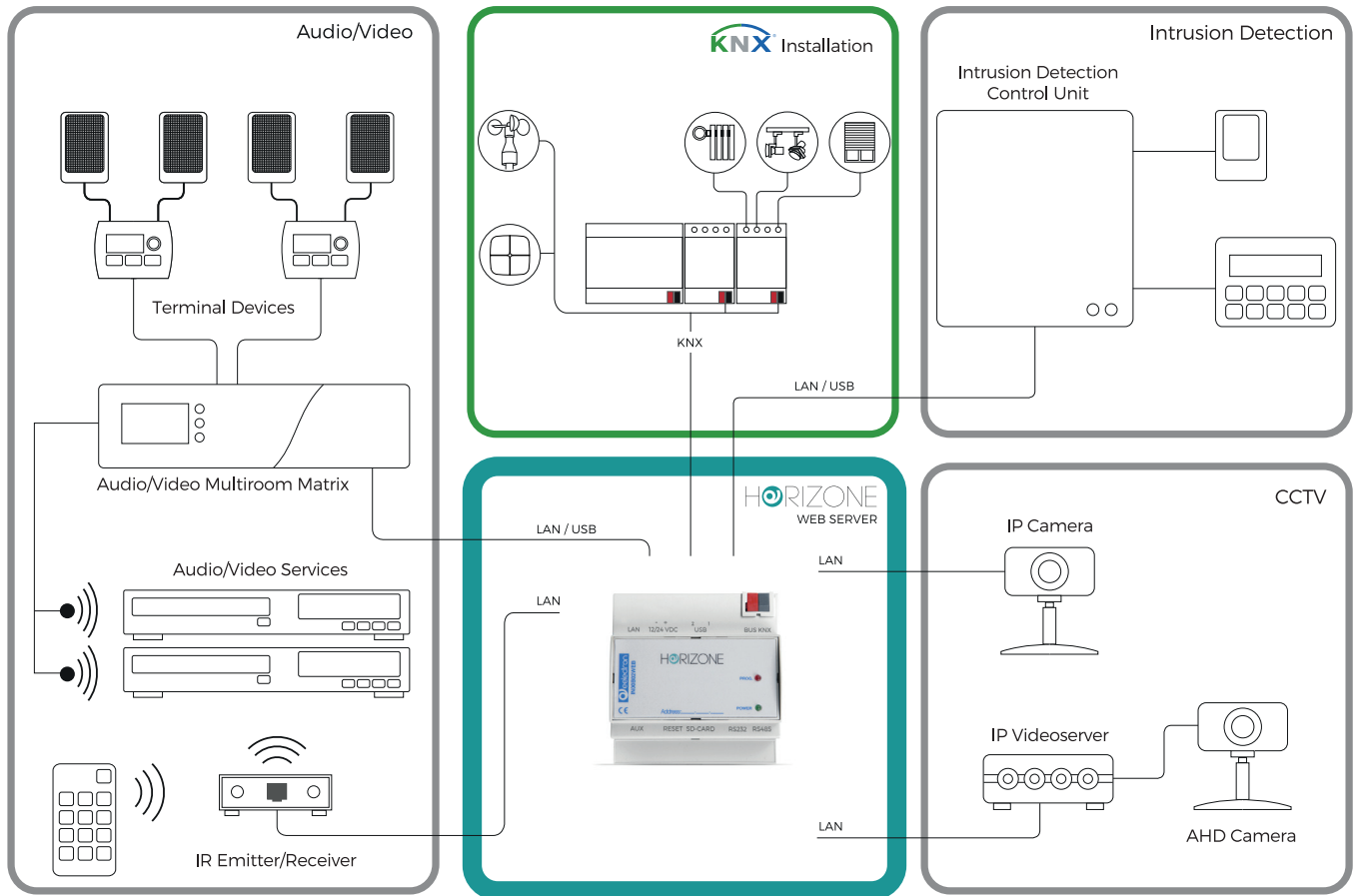

Horizone Virtual Badge

Virtual Badge is an innovative access control system, which allows the opening of gates with your smartphone, without the need for keys or badge readers physically installed in front of each door. The management of permission of the users, and the sending of virtual access keys, is entirely manageable via app, both locally and remotely, and is therefore ideal also for unattended structures.



Virtual Badge



Virtual Badge + Horizone Server

Target	<ul style="list-style-type: none"> • Access Control • Home automation management • Integration of bus and technological systems
Technology	<ul style="list-style-type: none"> • KNX • Anti-Intrusion Systems * • Audio Systems * • IP cameras * • Modbus *
Room 1-4	<ul style="list-style-type: none"> • Horizone Web Server + • Virtual Badge License + • Other license if required
Every 4 room	<ul style="list-style-type: none"> • Additional Virtual Badge License

* For compatibility list, see technical documentation for Horizone Web Server

Order Codes

IN00B02RAC-04

Access control module - 4 zones

IN00B02RAC-08

Access control module - 8 zones

IN00B02RAC-12

Access control module - 12 zones

IN00B02RAC-16

Access control module - 16 zones

IN00B02RAC-20

Access control module - 20 zones

IN00B02RAC-24

Access control module - 24 zones

IN00B02RAC-28

Access control module - 28 zones

IN00B02RAC-30

Access control module - 30 zones

IN00B02RAC-32

Access control module - 32 zones

IN00B02RAC-34

Access control module - 34 zones

IN00B02RAC-38

Access control module - 38 zones

IN00B02RAC-40

Access control module - 40 zones

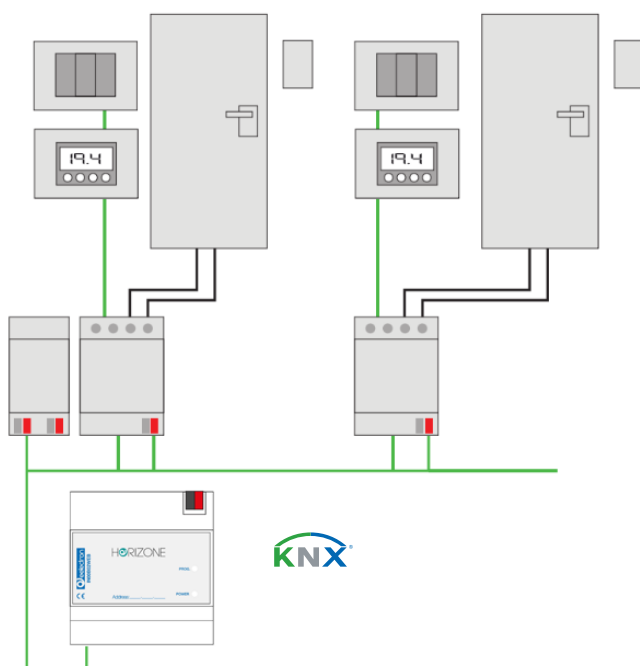

Horizone MINI Web Server

HORIZONE MINI is a webserver specifically engineered for supervision and monitoring of Home & Building Automation systems. Based on KNX standard and suitable for integration with Modbus standard*. Compatible with operating system Mac OS X, Microsoft Windows, Apple iOS and Google Android, the configuration and use of HORIZONE takes place directly through its web interface, which can be accessed through a the most popular browser on the market browser from any device (pc/mac, smartphone e tablet) or with free app available on iOS and Android store.

*Only for Modbus energy meter



Order Codes

IN00M02WEB
Horizone MINI Web Server 200 points

Software Features

Standard technologies	<ul style="list-style-type: none"> • KNX (max 200 group addresses) • RS485 / TCP • Energy meter USB
User interface	<ul style="list-style-type: none"> • Web / HTML5 • App iOS / Android
Number of clients	<ul style="list-style-type: none"> • Unlimited
Simultaneous connections	<ul style="list-style-type: none"> • Up to 20
Features	<ul style="list-style-type: none"> • Lighting • HVAC • Blinds / Shutters • Irrigation • Alarms • Energy management • Load management • Weather • Door intercom system (with SIP standard) • SONOS • Cloud services • Voice control • IFTTT
Advanced functions	<ul style="list-style-type: none"> • Scenarios with parametrical wait functions • Boolean logics • Thresholds and values comparators • Mathematical operations • Scheduler • Programmable events • Notifications

SIZES

	KNX GROUP ADDRESSES	SCENES	LOGICS	PAGES	LOADS
Horizone Web Server 200 KNX group addresses	200	30	30	12	10

Hardware Features

Dimensions	<ul style="list-style-type: none"> • 90,5 x 62 x 36 mm • 2 DIN rail Module
Aux Supply	<ul style="list-style-type: none"> • 12 ÷ 24 Vdc • 18 mA @12 V; 110 mA @24 V
Communication ports	<ul style="list-style-type: none"> • KNX • RS485 (1x) Screw connector • USB 2.0 (1x) • LAN (1x) RJ-45 jack (10/100 Mbps)

Energy Meter USB

USB ENERGY METER

This is an indirect insertion single-phase energy meter for DIN rail mounting and the connection is made via USB with the Horizone webserver or Horizone Mini.

Through the user interface of the web server to which it is connected, it allows monitoring of the power, voltage and current relative to the point where it is mounted. Thanks to the amperometric clamp supplied, with opening insertion, it is possible to measure any electrical phase available in the electrical panel, without having to intervene directly in the relative wiring. To work requires a free USB port on the Horizone or Horizone Mini webserver.

Order Codes

PM10M01USB
USB Energy Meter